

ASSEMBLY INSTRUCTIONS

CONVERSION KIT FOR 1/5TH SCALE BAJA

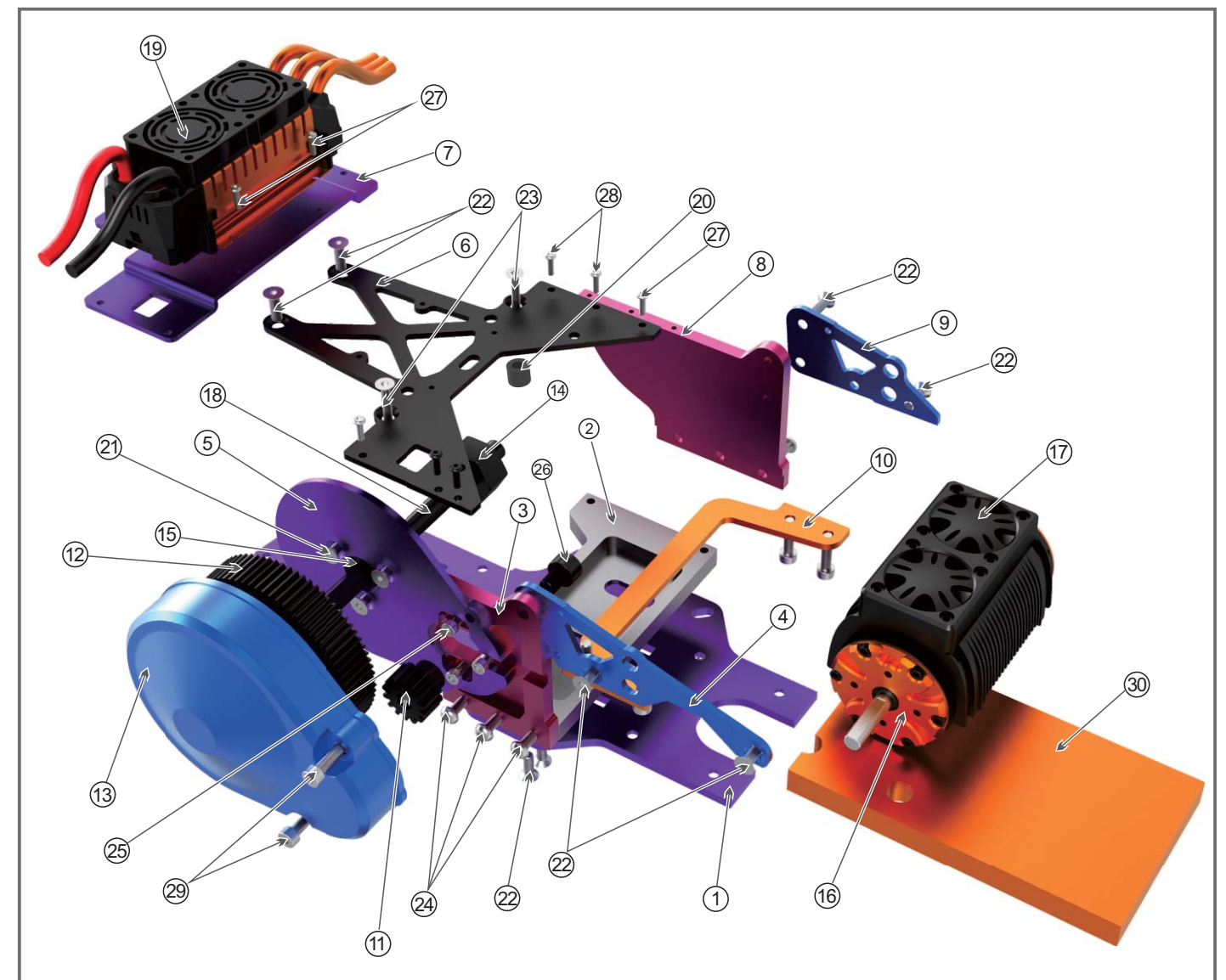

Item No.	Description	QTY
1	Baja Stock Car Base Plate*	1
2	Base Plate	1
3	Motor Mount Plate	1
4	Passenger Frame Plate	1
5	Gear Cover Plate	1
6	Diff Plate	1
7	ESC Mount Plate	1
8	Motor Mount Plate	1
9	Driver Frame Plate	1
10	Lateral Brace	1
11	14T MOD1.5Pinion	1
12	Baja Stock Spur*	1
13	Baja Stock Gear Guard*	1
14	Baja Stock Part*	1
15	12x24x6 Bearing*	1

Item No.	Description	QTY
16	X528Motor*	1
17	Dual Fan Shroud*	1
18	Baja Stock Shaft*	1
19	1/5 ESC*	1
20	Diff Spacer*	1
21	M5×10mm Flat Head Cap Screw	3
22	M5×16mm Flat Head Cap Screw	9
23	M4×30mm Flat Head Cap Screw	2
24	M5×16mm Button Head Cap Screw	8
25	M4×8mm Socket Head Cap Screw	3
26	M8×10mm Socket Head Cap Screw	1
27	M3×8mm Button Head Cap Screw	8
28	M3×10mm Button Head Cap Screw	4
29	M5×20mm Socket Head Cap Screw	6
30	Battery Pad	1

* Please note that items with * are not included in the package.

Tools and materials you will need:

- 2mm hex wrench
- 3mm hex wrench
- 4mm hex wrench
- 6mm hex wrench
- green threadlocker

Note:

wait until all parts are assembled before tightening screws. Refer to Baja manual for gas engine removal instructions.

1. Place **Diff Plate**(item6) to the lower rear shock brace of the car with two **M5×16mm long flat head cap screws**(item22) along with **Diff Spacer**(item20) and two **M4×30mm long flat head cap screws**(item23) like figure 1.
2. Connect **Base Plate**(item7) to the **Diff Plate**(item6) by two **M3×8mm long flat head cap screws**(item27).
3. Equip **Base Plate**(item2) with two **M5×16mm Long flat head cap screws**(item22) and two **M5×16mm long button head cap Screws**(item24) to the base plate of the car's frame(item1) as shown in figure 3.
4. Put the **existing 12×24×6 bearing**(item15) from the vehicle into the corresponding counter bored hole into **Motor Mount Plate**(item3) and then mount the **X528 motor**(item16) to **Motor Mount Plate**(item3) using three **M4×8mm long socket head cap screws**(item25). See figure 4.
5. As the bearing facing out, glide it over the car's drive shaft and protect the **Motor Mount Plate**(item3) to **Base Plate**(item2) with three **M5×16mm long button head cap screws**(item24) and **Diff Plate**(item6) with two **M3×10mm long button head cap screws**(item28) referring to figure5.
6. Assemble **Lateral Brace**(item10) between the frame and roll cage using four **M5×20mm socket head cap screws**(item29). Protect **Box Frame Plate**(item8) to **Base Plate**(item2) with three **M5×16mm long button head cap screws**(item24) while **Diff Plate**(item6) using two **M3×10mm long button head cap screws**(item28). Refer to figure 6.

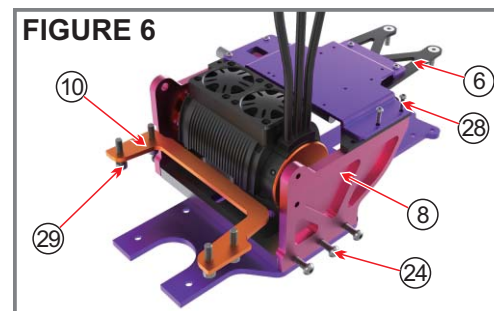
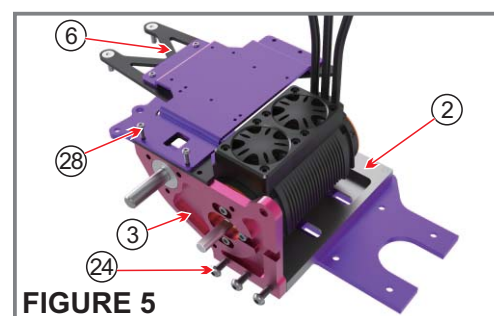
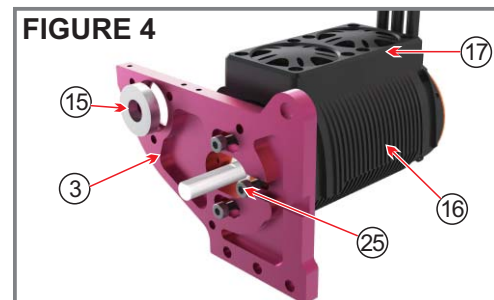
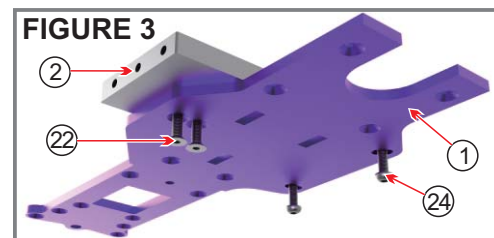
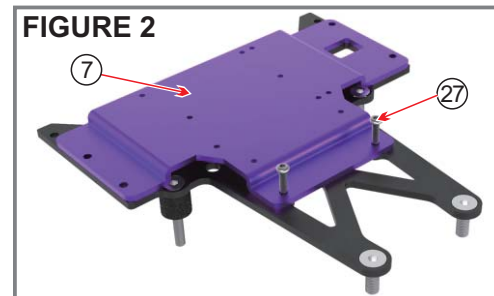
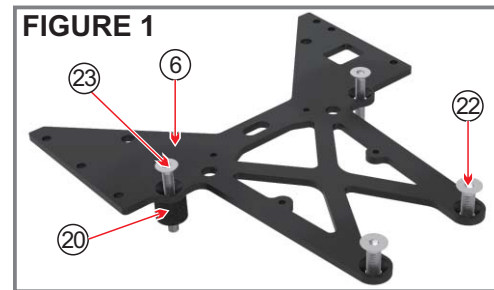

7. As shown in figure7, use one **M8×10mm long socket head cap screw**(item26) to mount **Passenger Frame Plate**(item4) to **Motor Mount Plate**(item3) and the roll cage using two **M5×16mm long flat head cap screws**(item22).
8. Tighten **Diff Plate**(item6) with two **M3×8mm long button head cap screws**(item27). Mount **Driver Frame Plate**(item9) to **Box Frame Plate**(item8) with two **M5×16mm long flat head cap screws**(item22) and roll cage with one **M5×16mm long flat head cap screw**(item22). See figure8.
9. Place **Gear Cover Plate**(item5) onto **Motor Mount Plate**(item3) using three **M5×10mm long flat head cap screws**(item21) as shown in figure 9.
10. At present, tighten all screws.
11. Replace the spur gear spacer above the drive shaft.
12. Displace the stock spur gear and "E" clip.
13. Slide the desired 1.5pinion onto the motor shaft when the motor mounting screws loose. Make proper gear mesh. Sliding the motor sideways can adjust. Tighten the motor mount screws as soon as the proper mesh is achieved. You may be able to slide the pinion off of the motor shaft to obtain the motor mounting screws.
14. Adjust the pinion and motor properly, and then you can align the set screw in the pinion on the flat on the motor shaft and tighten set screw.
Note: adopt a few of green thread lock between motor shaft and pinion.
15. Assemble **Gear Guard**(item13) onto **Gear Cover Plate**(item5) using two **M5×20mm long socket head cap screws**(item29).
16. Place the **1/5 ESC**(item19) onto **Diff Plate**(item6) with four **M3×8mm long button head cap screws**(item27).
17. Please refer to figure 11 once you finish all of the steps.
Note: in order to secure your batteries, bind the Velcro strap across the vehicle's upper frame rails.

